

Material List:

2-13/16" x 1-3/4"	6063-T52	Rect. Type	Top Cap (Shown)
2" x 2" x 1/4"	6061-T6	Sq. Tube	Support Post
1"x1-1/2"x1/8"	6063-T52	Rect. Tube	Bottom Rail
1/2"x1/2"x1/16"	6063-T52	Sq. Tube	Perimeter Channel
1/8" Sheet	6063-T52	Perforated	1/4" Holes @ 1/2" Stagger.
1/8" Sheet	6063-T52	Perforated	Various Patterns (Option)
5" x 6" x 3/8"	6061-T6	CNC Cut	Base Plate (Option)

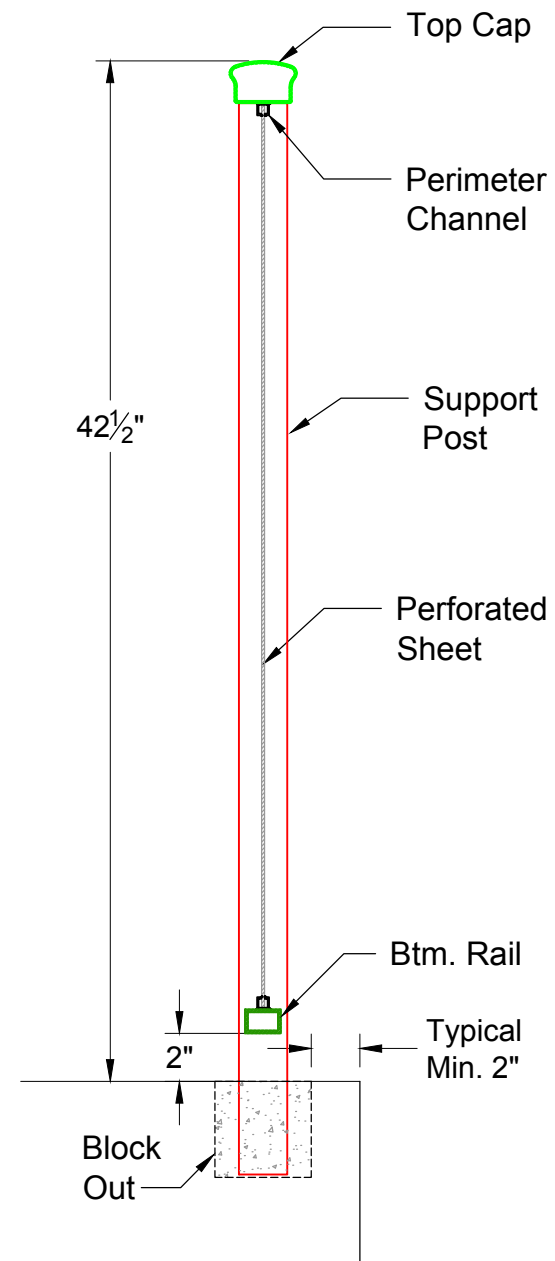

ENLARGED SECTION 1 1/2" = 1' - 0"

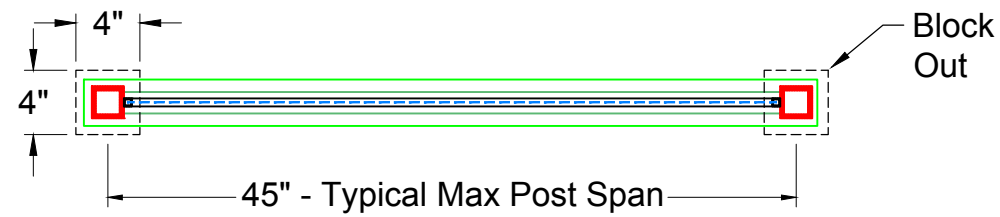

PLAN VIEW 1" = 1' - 0"

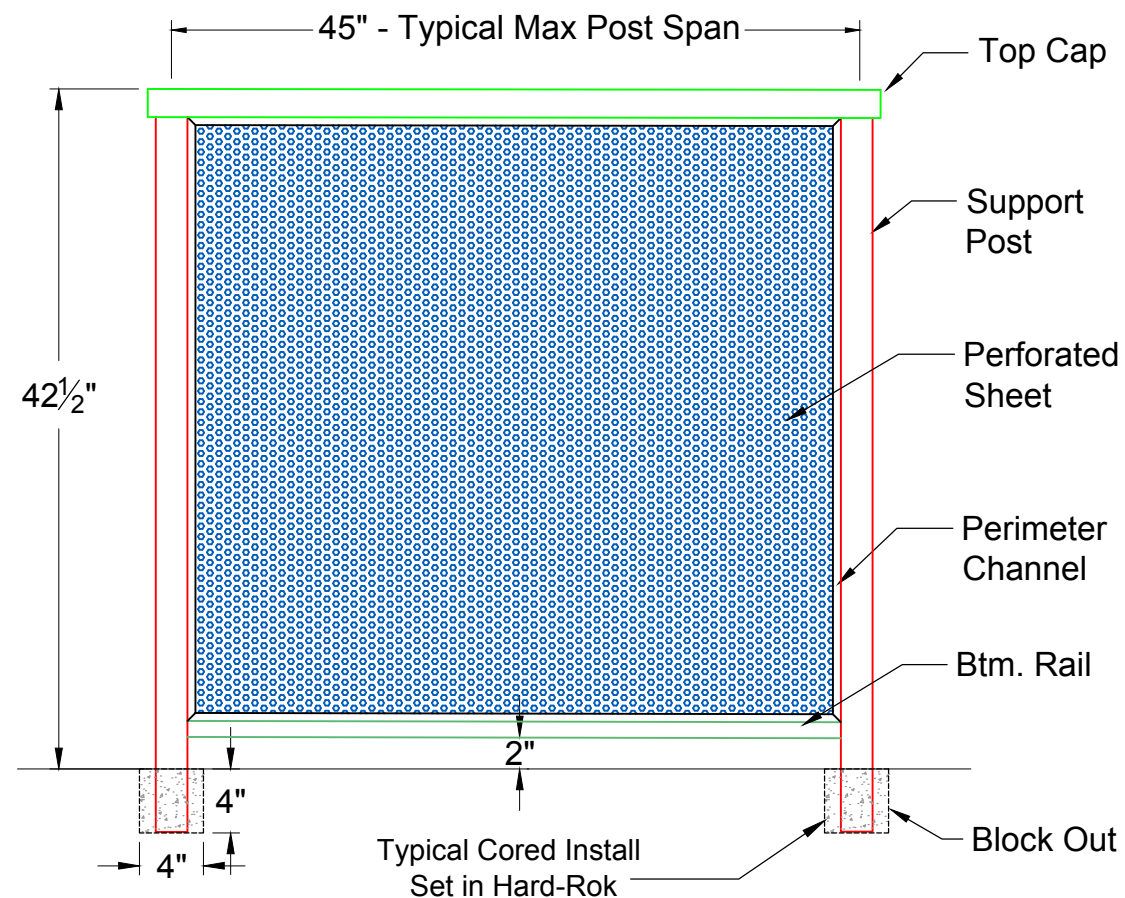

ELEVATION 1" = 1' - 0"

Dimensions and Components may vary based on Site Specific Engineering

All rights reserved and are the property of Mullet's Aluminum Products, Inc. No part of the materials may be copied, photocopied, reproduced, translated or reduced to any electronic medium or machine-readable form, in whole or in part, without prior written consent of Mullet's Products, Inc. All materials are protected by United States Copyright Law.

Customer: **MULLET'S ALUMINUM**

Project Name: **PERFORATED RAIL**

Date: May. 23, 19

Drawn By: Nick, L.

Scale: AS NOTED

Drawing Description: **PRS - 100 Typ. Core Mount** Page: (1)



6345 McIntosh Road Office # (941) 371 - 3502
Sarasota, FL 34238 Fax # (941) 378 - 5676

Material List:

2-13/16" x 1-3/4"	6063-T52	Rect. Type	Top Cap (Shown)
2" x 2" x 1/4"	6061-T6	Sq. Tube	Support Post
1"x1-1/2"x1/8"	6063-T52	Rect. Tube	Bottom Rail
1/2"x1/2"x1/16"	6063-T52	Sq. Tube	Perimeter Channel
1/8" Sheet	6063-T52	Perforated	1/4" Holes @ 1/2" Stagger.
1/8" Sheet	6063-T52	Perforated	Various Patterns (Option)
5" x 6" x 3/8"	6061-T6	CNC Cut	Base Plate (Option)

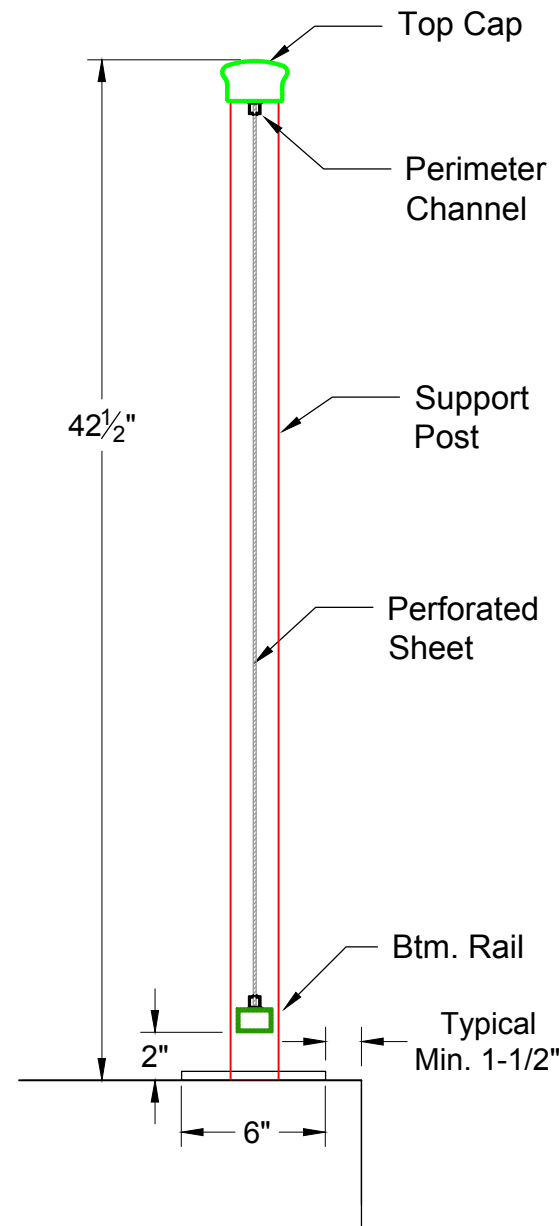

ENLARGED SECTION 1/2" = 1' - 0"

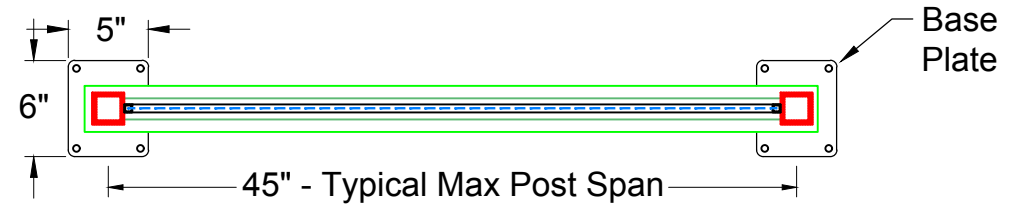

PLAN VIEW 1" = 1' - 0"

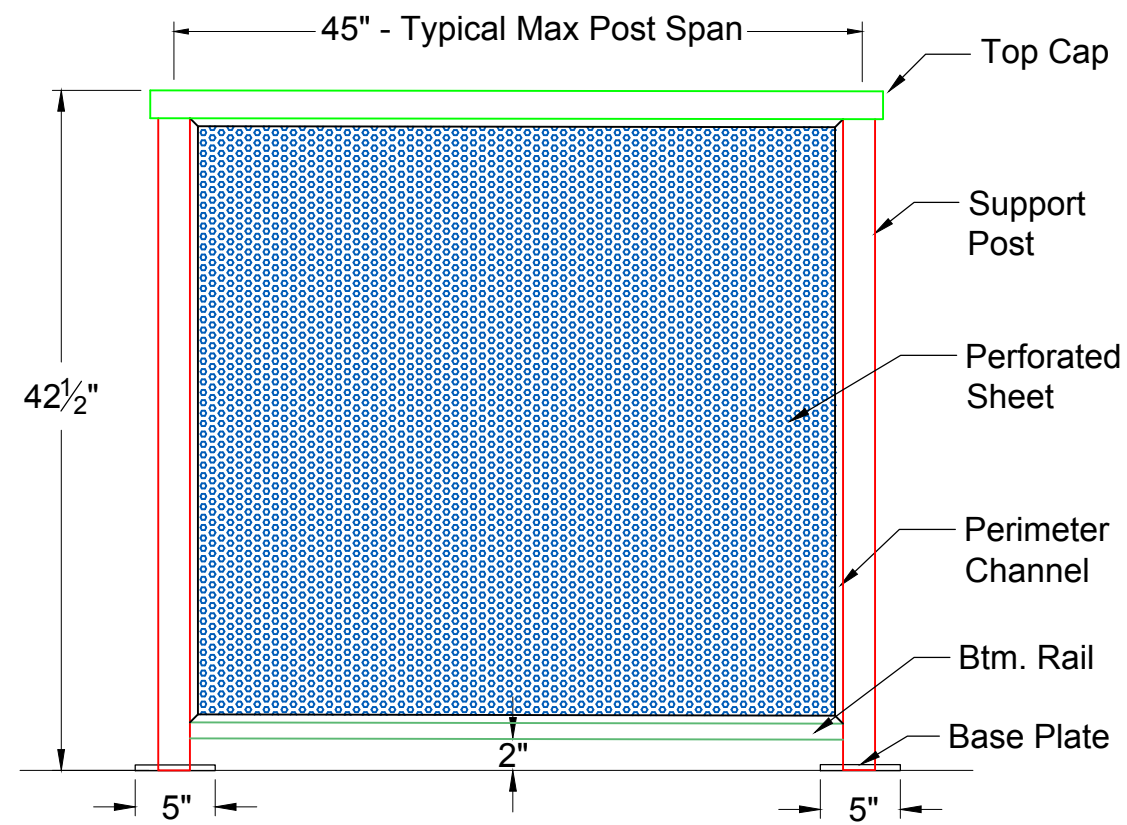

ELEVATION 1" = 1' - 0"

Dimensions and Components may vary based on Site Specific Engineering

All rights reserved and are the property of Mullet's Aluminum Products, Inc. No part of the materials may be copied, photocopied, reproduced, translated or reduced to any electronic medium or machine-readable form, in whole or in part, without prior written consent of Mullet's Products, Inc. All materials are protected by United States Copyright Law.

Date:	May. 23, 19	Customer:	MULLET'S ALUMINUM
Drawn By:	Nick, L.	Project Name:	PERFORATED RAIL
Scale:	AS NOTED	Drawing Description:	PRS - 100 Opt. Plate Mount
			Page : (2)

MULLET'S ALUMINUM PRODUCTS INC.
 WELDING FABRICATION DEPT.
 6345 McIntosh Road Office # (941) 371 - 3502
 Sarasota, FL 34238 Fax # (941) 378 - 5676

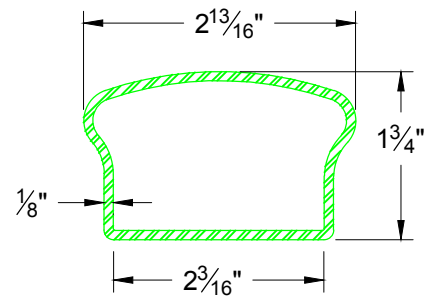

TOP CAP (SHOWN)
137

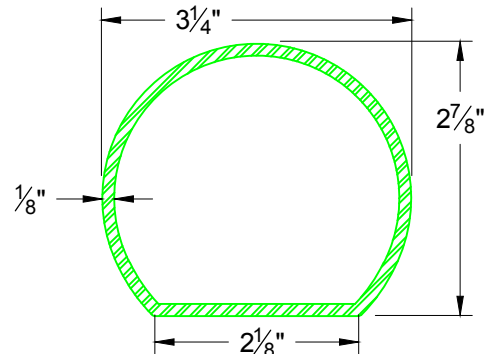

TOP CAP OPTION
MA 3"

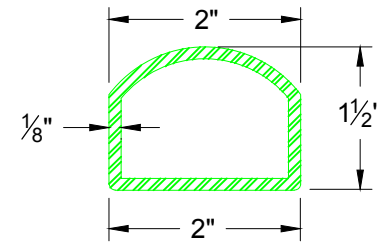

TOP CAP OPTION
MA 14

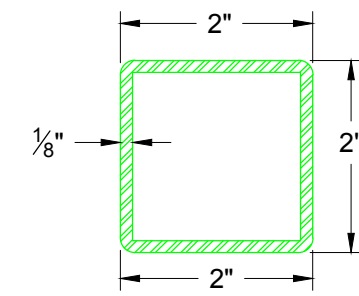

TOP CAP OPTION
SQ 2"

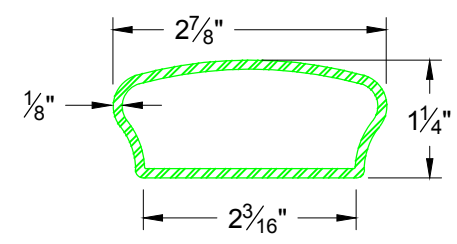

TOP CAP OPTION
133

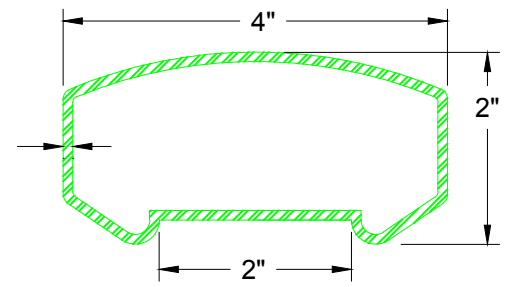

TOP CAP OPTION
152

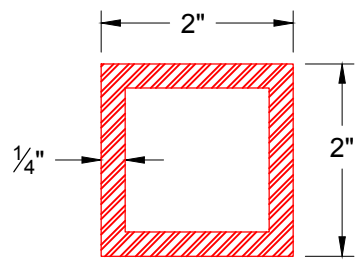

SUPPORT POST

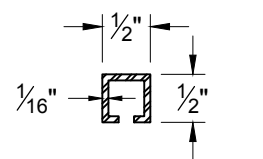

PERIMETER CHANNEL

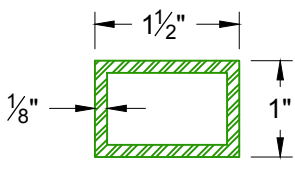

BOTTOM RAIL

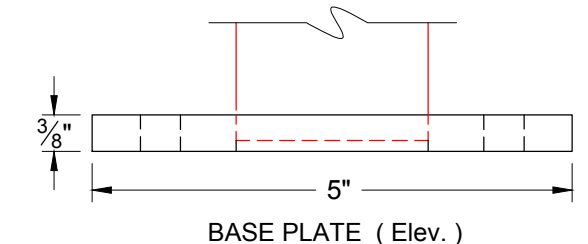

BASE PLATE (Elev.)

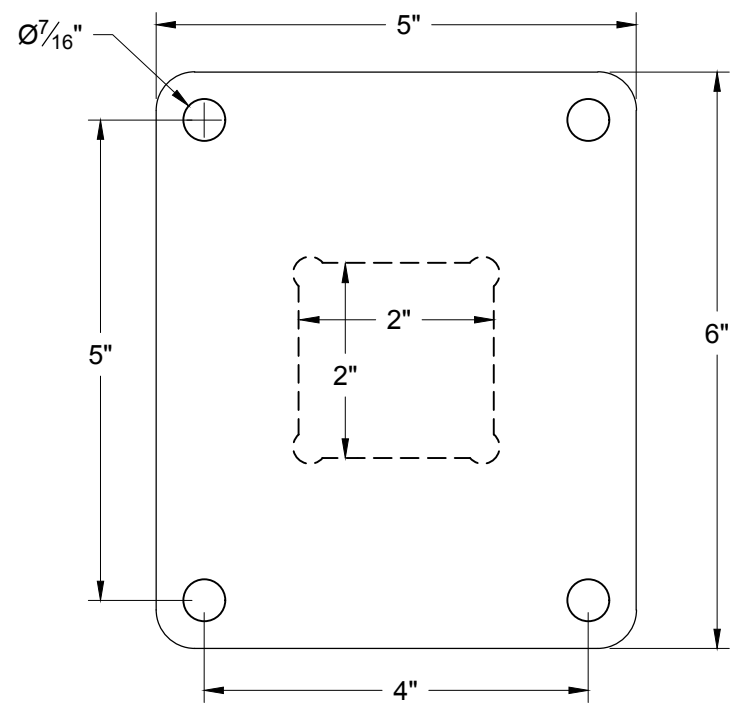

BASE PLATE (Plan)

(BASE PLATE OPTION SUBJECT TO ENGINEERING)

Material List:

2-13/16" x 1-3/4"	6063-T52	Rect. Type	Top Cap (Shown)
2" x 2" x 1/4"	6061-T6	Sq. Tube	Support Post
1"x1-1/2"x1/8"	6063-T52	Rect. Tube	Bottom Rail
1/2"x1/2"x1/16"	6063-T52	Sq. Tube	Perimeter Channel
1/8" Sheet	6063-T52	Perforated	1/4" Holes @ 1/2" Stagger.
1/8" Sheet	6063-T52	Perforated	Various Patterns (Option)
5" x 6" x 3/8"	6061-T6	CNC Cut	Base Plate (Option)

Dimensions and Components may vary based on Site Specific Engineering

All rights reserved and are the property of Mullet's Aluminum Products, Inc. No part of the materials may be copied, photocopied, reproduced, translated or reduced to any electronic medium or machine-readable form, in whole or in part, without prior written consent of Mullet's Products, Inc. All materials are protected by United States Copyright Law.

Customer: **MULLET'S ALUMINUM**

Project Name: **PERFORATED RAIL**

Date: May. 23, 19

Drawn By: Nick, L.

Scale: 6" = 1'-0"

Drawing Description: **PRS - 100 Component List** Page: **(3)**



6345 McIntosh Road
Sarasota, FL 34238
Office # (941) 371-3502
Fax # (941) 378-5676