

**Material List:**

3"x 1-1/4"x 1/8"	6063-T52 Oval Tube	Top Cap ( Shown )
13/16" x 1/8"	6061-T6 1/2" Sch 40-P	Horizontal Rail
2" x 1/2"	6061-T6 Flat Bar	Support Post
1/2" Thick	6061-T6 CNC Cut	Post Base Doubler
1/2" Thick	6061-T6 CNC Cut	Base Plates ( Option )

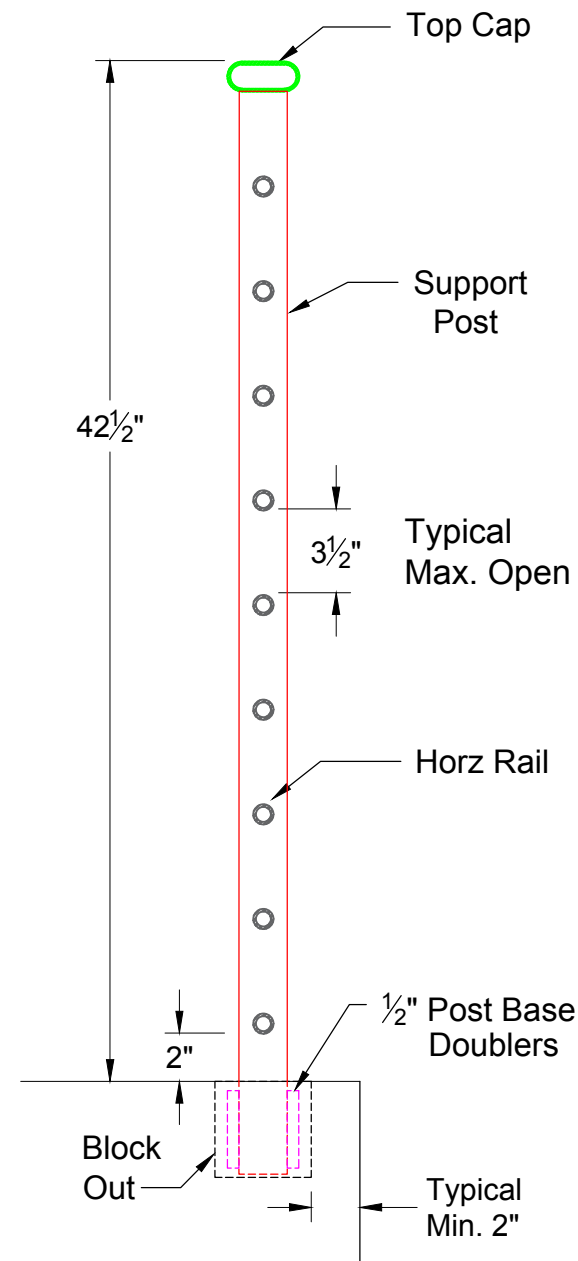

**ENLARGED SECTION** 1 1/2" = 1' - 0"

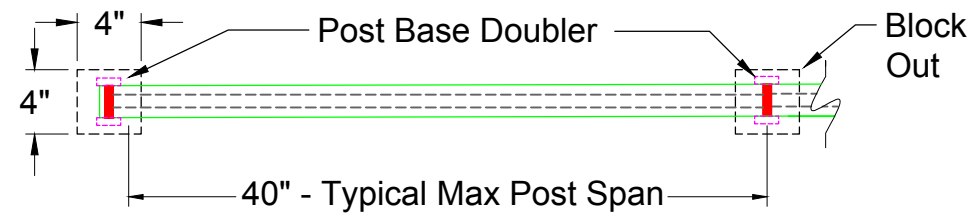

**PLAN VIEW** 1" = 1' - 0"

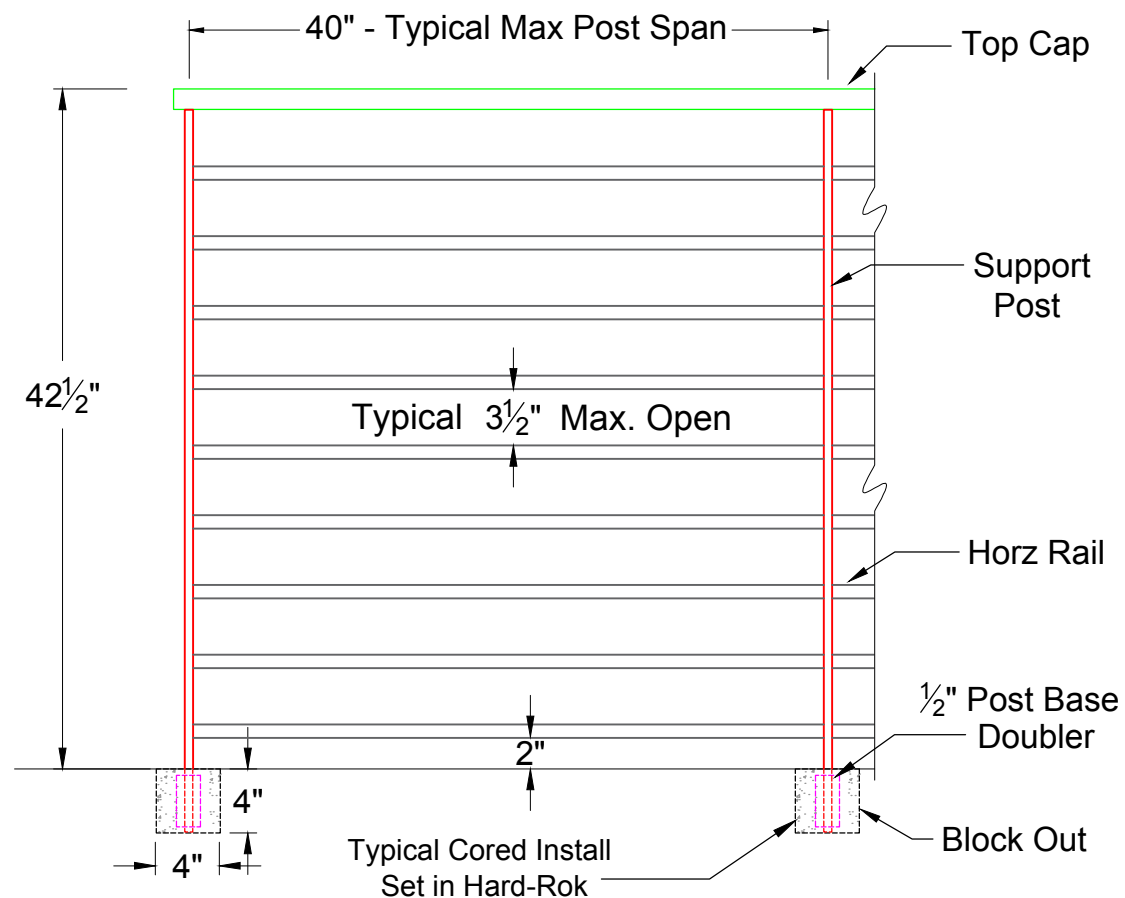

**ELEVATION** 1" = 1' - 0"

Dimensions and Components may vary based on Site Specific Engineering

All rights reserved and are the property of Mullet's Aluminum Products, Inc. No part of the materials may be copied, photocopied, reproduced, translated or reduced to any electronic medium or machine-readable form, in whole or in part, without prior written consent of Mullet's Products, Inc. All materials are protected by United States Copyright Law.

Date:	Customer:
May. 23, 19	<b>MULLET'S ALUMINUM</b>
Drawn By:	Project Name:
Nick, L.	
Scale:	Drawing Description:
AS NOTED	HRS - 300 Typ. Core Mount
	Page: ( 1 )

**MULLET'S ALUMINUM PRODUCTS INC.**  
 WELDING FABRICATION DEPT.  
 6345 McIntosh Road Office # ( 941 ) 371 - 3502  
 Sarasota, FL 34238 Fax # ( 941 ) 378 - 5676

**Material List:**

3"x 1-1/4"x 1/8"	6063-T52 Oval Tube	Top Cap ( Shown )
13/16" x 1/8"	6061-T6 1/2" Sch 40-P	Horizontal Rail
2" x 1/2"	6061-T6 Flat Bar	Support Post
1/2" Thick	6061-T6 CNC Cut	Post Base Doubler
1/2" Thick	6061-T6 CNC Cut	Base Plates ( Option )

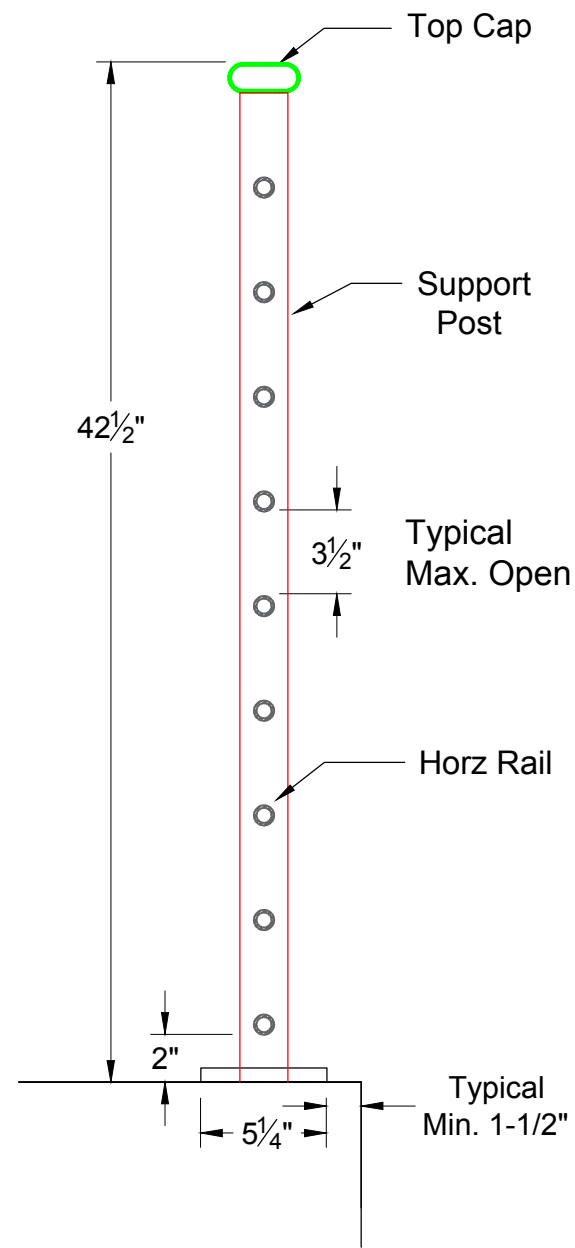

**ENLARGED SECTION** 1/2" = 1' - 0"

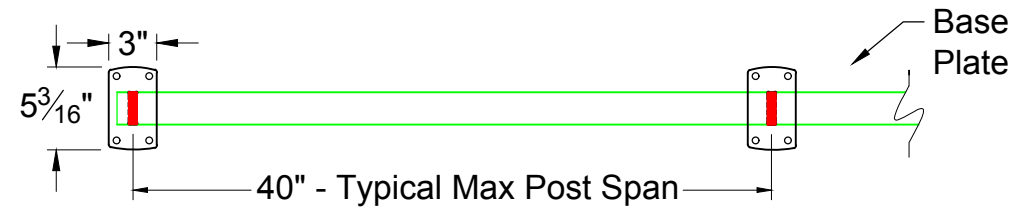

**PLAN VIEW** 1" = 1' - 0"

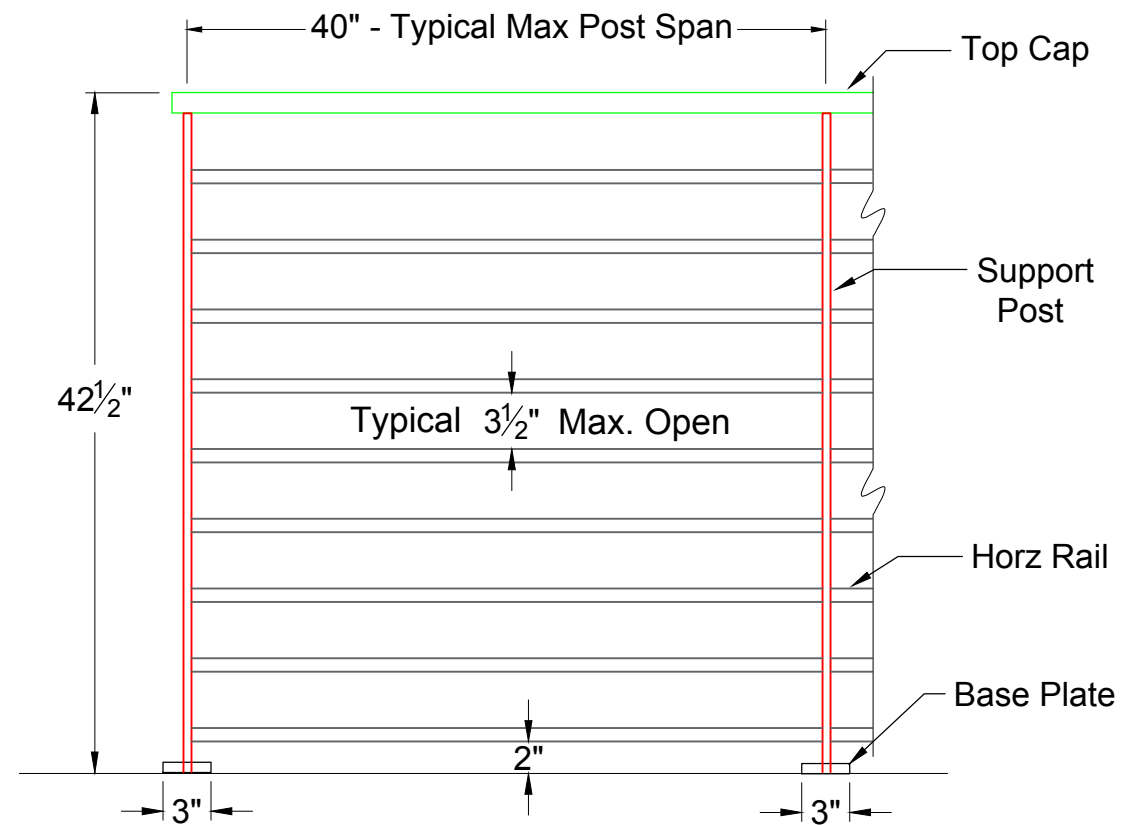

**ELEVATION** 1" = 1' - 0"

All rights reserved and are the property of Mullet's Aluminum Products, Inc. No part of the materials may be copied, photocopied, reproduced, translated or reduced to any electronic medium or machine-readable form, in whole or in part, without prior written consent of Mullet's Products, Inc. All materials are protected by United States Copyright Law.

Customer: **MULLET'S ALUMINUM**

Date: May. 23, 19  
 Drawn By: Nick, L.  
 Scale: AS NOTED

Page: (2)

Drawing Description: HRS - 300 Opt. Plate Mount

**MULLET'S ALUMINUM PRODUCTS INC.**  
 WELDING FABRICATION DEPT.  
 6345 McIntosh Road Office # (941) 371-3502  
 Sarasota, FL 34238 Fax # (941) 378-5676

Dimensions and Components may vary based on Site Specific Engineering

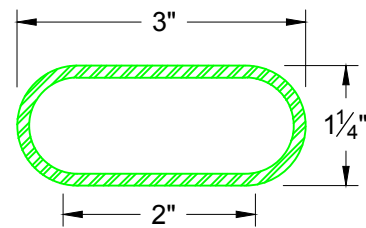

TOP CAP ( SHOWN )  
3" x 1-1/4" OVAL TUBE

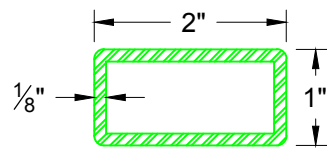

TOP CAP OPTION  
2" x 1" TUBE RAD. EDGE

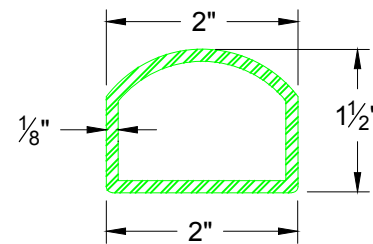

TOP CAP OPTION  
# MA 14

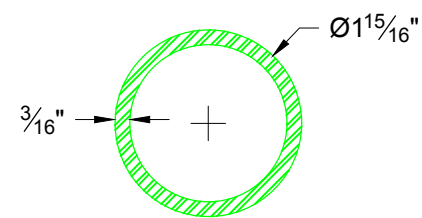

TOP CAP OPTION  
1-1/2" SCH 40 -PIPE

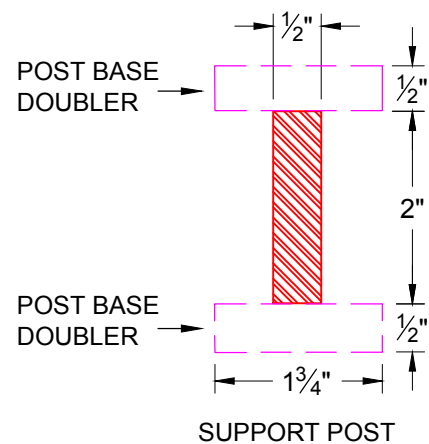

SUPPORT POST

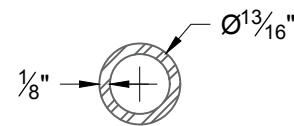

HORZ RAIL  
1/2" SCH 40 -PIPE

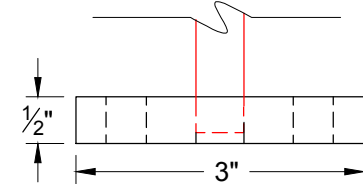

BASE PLATE ELEV.

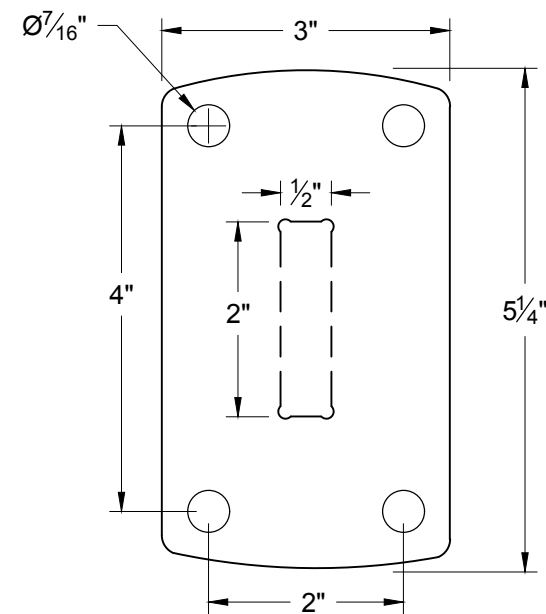

BASE PLATE PLAN

( BASE PLATE OPTION SUBJECT TO ENGINEERING )

**Material List:**

3"x 1-1/4"x 1/8"	6063-T52 Oval Tube	Top Cap ( Shown )
13/16" x 1/8"	6061-T6 1/2" Sch 40-P	Horizontal Rail
2" x 1/2"	6061-T6 Flat Bar	Support Post
1/2" Thick	6061-T6 CNC Cut	Post Base Doubler
1/2" Thick	6061-T6 CNC Cut	Base Plates ( Option )

Dimensions and Components may vary based on Site Specific Engineering

All rights reserved and are the property of Mullet's Aluminum Products, Inc. No part of the materials may be copied, photocopied, reproduced, translated or reduced to any electronic medium or machine-readable form, in whole or in part, without prior written consent of Mullet's Products, Inc. All materials are protected by United States Copyright Law.

Customer: **MULLET'S ALUMINUM**

Date: May. 23, 19

Project Name:

Drawn By: Nick, L.

Scale: N.T.S.

Drawing Description: HRS - 300 Component List

Page: (3)



WELDING FABRICATION DEPT.

6345 McIntosh Road Office # ( 941 ) 371 - 3502  
Sarasota, FL 34238 Fax # ( 941 ) 378 - 5676