

Material List:

2-7/8" x 1/8"	6063-T52 #133	Top Cap (Shown)
2" x 2" x 1/8"	6061-T6 Sq. Tube	Support Posts
1" x 1" x 1/16"	6063-T52 Sq. Tube	Vertical Picket
1-1/2" x 1" x 1/8"	6063-T52 Rect. Tube	Bottom Rail
5" x 5" x 3/8"	6061-T6 CNC Cut	Base Plate (Option)

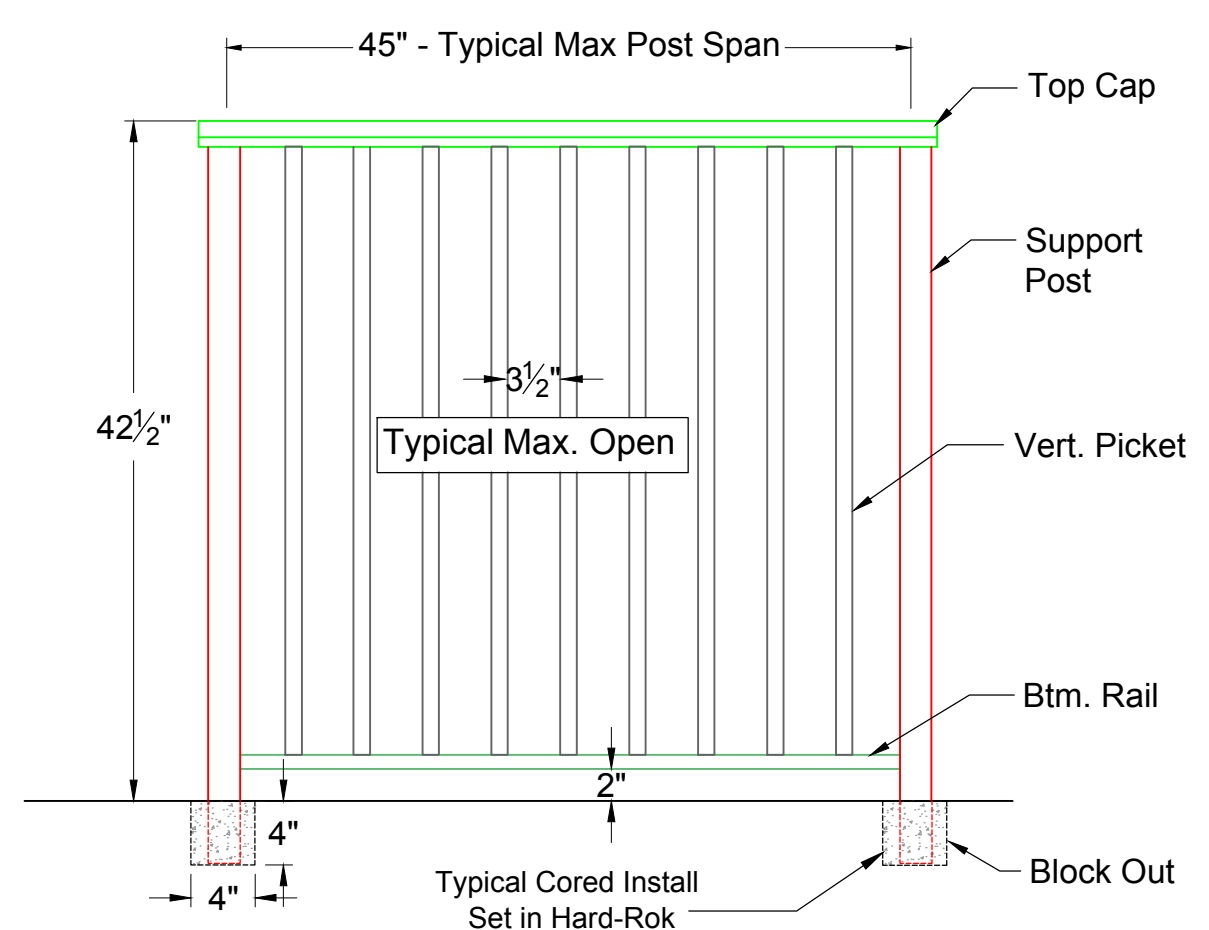
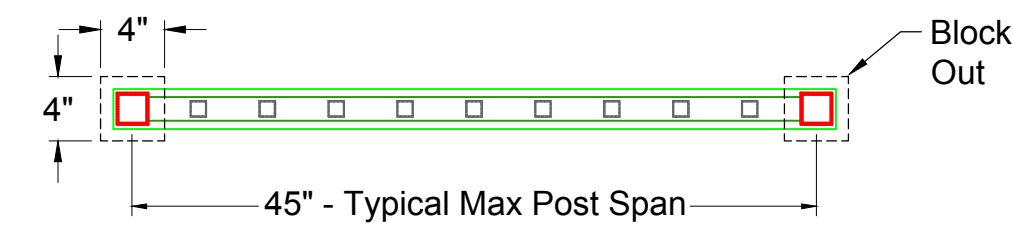
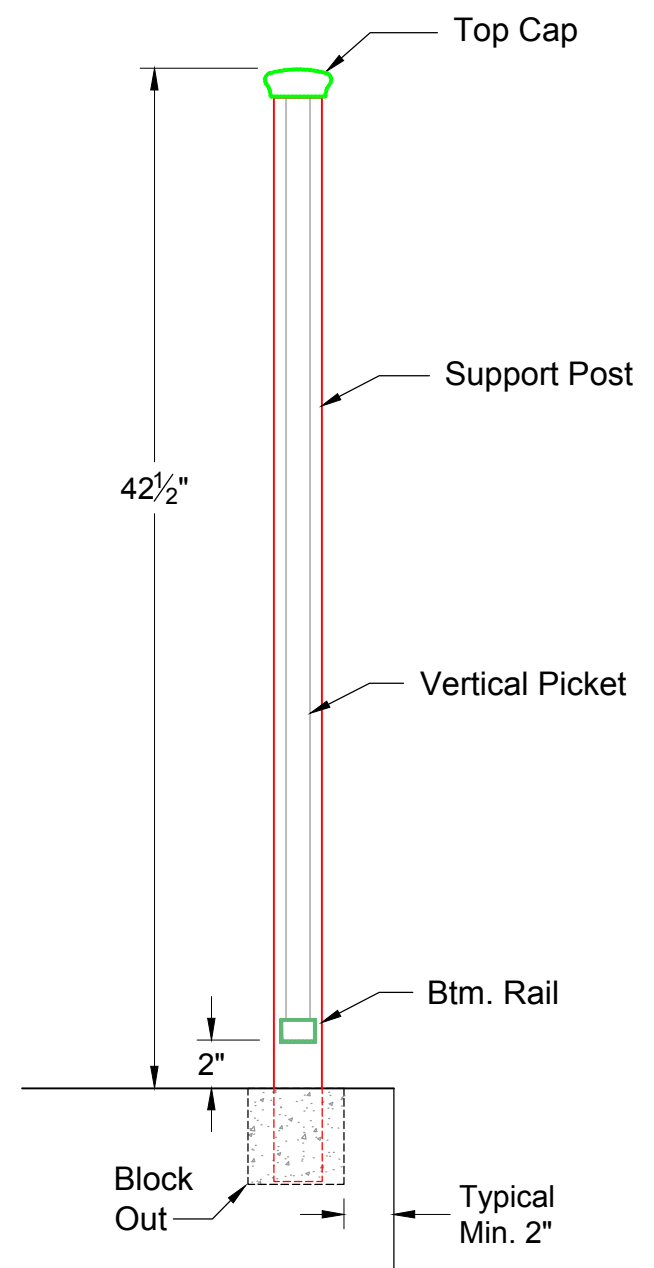

ENLARGED SECTION 1/2" = 1' - 0"

ELEVATION 1" = 1' - 0"

Dimensions and Components may vary based on Site Specific Engineering

All rights reserved and are the property of Mullet's Aluminum Products, Inc. No part of the materials may be copied, photocopied, reproduced, translated or reduced to any electronic medium or machine-readable form, in whole or in part, without prior written consent of Mullet's Products, Inc. All materials are protected by United States Copyright Law.

Date:	Customer:
May. 23, 19	MULLET'S ALUMINUM
Drawn By:	Project Name:
Nick, L.	VERTICAL PICKET RAIL
Scale:	Drawing Description:
AS NOTED	VRS - 100 Typ. Core Mount
	Page: (1)

MULLET'S ALUMINUM PRODUCTS INC.
WELDING FABRICATION DEPT.
6345 McIntosh Road Office # (941) 371 - 3502
Sarasota, FL 34238 Fax # (941) 378 - 5676

Material List:

2-7/8" x 1/8"	6063-T52 #133	Top Cap (Shown)
2" x 2" x 1/8"	6061-T6 Sq. Tube	Support Posts
1" x 1" x 1/16"	6063-T52 Sq. Tube	Vertical Picket
1-1/2" x 1" x 1/8"	6063-T52 Rect. Tube	Bottom Rail
5" x 5" x 3/8"	6061-T6 CNC Cut	Base Plate (Option)

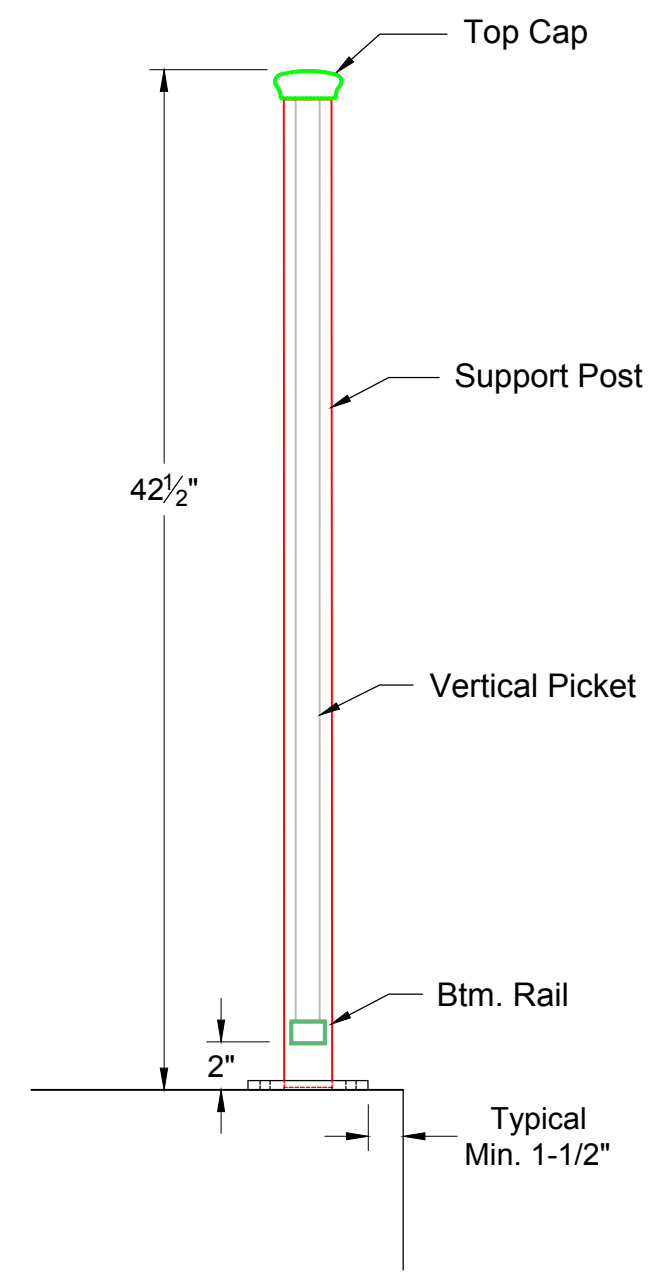

ENLARGED SECTION 1 1/2" = 1' - 0"

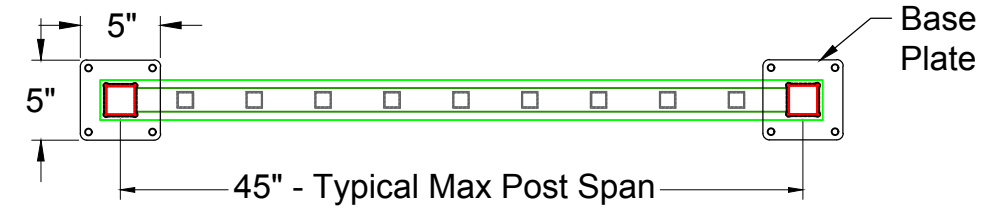

PLAN VIEW 1" = 1' - 0"

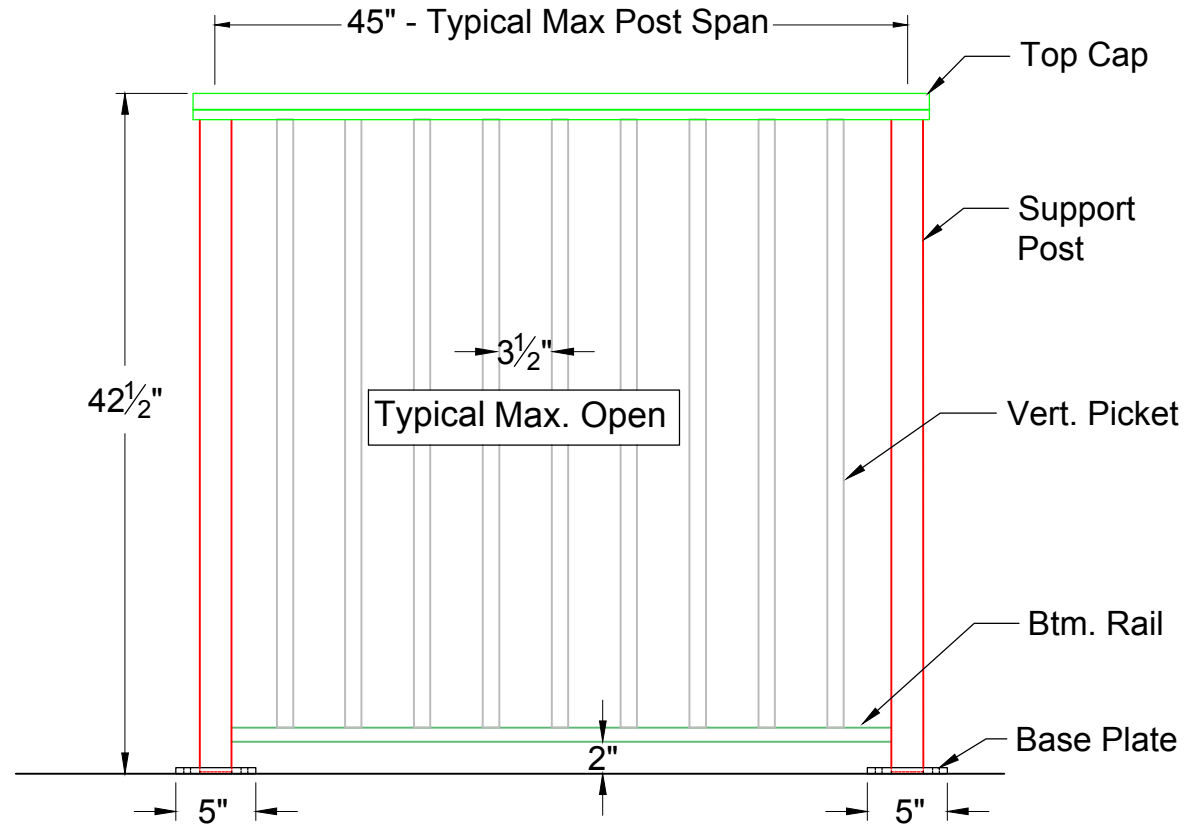

ELEVATION 1" = 1' - 0"

Dimensions and Components may vary based on Site Specific Engineering

All rights reserved and are the property of Mullet's Aluminum Products, Inc. No part of the materials may be copied, photocopied, reproduced, translated or reduced to any electronic medium or machine-readable form, in whole or in part, without prior written consent of Mullet's Products, Inc. All materials are protected by United States Copyright Law.

Date:	Customer:
May. 23, 19	MULLET'S ALUMINUM
Drawn By:	Project Name:
Nick, L.	VERTICAL PICKET RAIL
Scale:	Drawing Description:
AS NOTED	VRS - 100 Opt. Plate Mount
	Page: (2)

MULLET'S ALUMINUM PRODUCTS INC.
WELDING FABRICATION DEPT.
6345 McIntosh Road Office # (941) 371 - 3502
Sarasota, FL 34238 Fax # (941) 378 - 5676

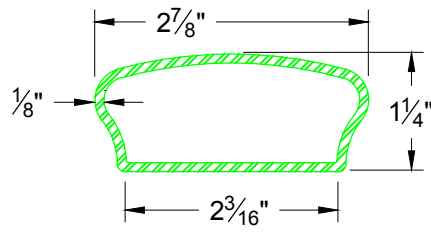

TOP CAP (SHOWN)
133

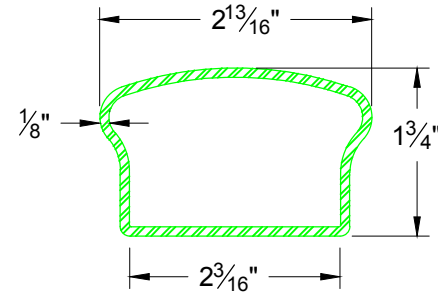

TOP CAP OPTION
137

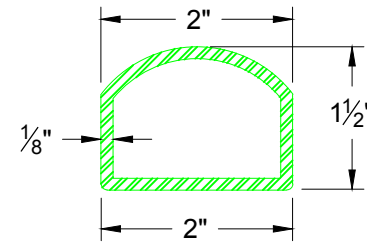

TOP CAP OPTION
MA 14

Material List:

- | | | |
|--------------------|---------------------|-----------------------|
| 2-7/8" x 1/8" | 6063-T52 #133 | Top Cap (Shown) |
| 2" x 2" x 1/8" | 6061-T6 Sq. Tube | Support Posts |
| 1" x 1" x 1/16" | 6063-T52 Sq. Tube | Vertical Picket |
| 1-1/2" x 1" x 1/8" | 6063-T52 Rect. Tube | Bottom Rail |
| 5" x 5" x 3/8" | 6061-T6 CNC Cut | Base Plate (Option) |

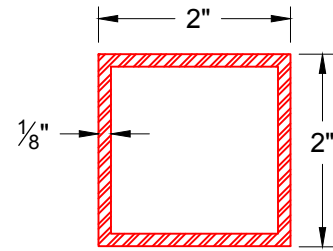

SUPPORT POST

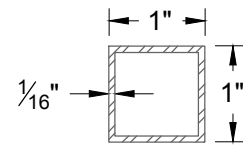

VERTICAL PICKET

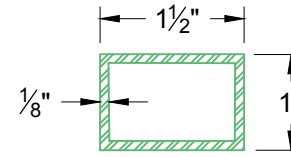

BOTTOM RAIL

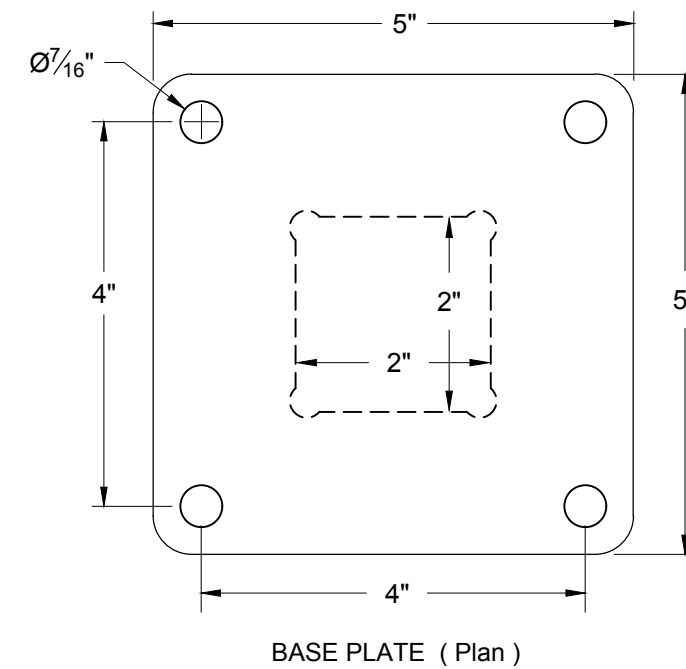
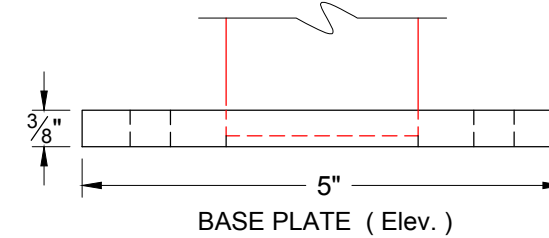

(BASE PLATE OPTION SUBJECT TO ENGINEERING)

All rights reserved and are the property of Mullet's Aluminum Products, Inc. No part of the materials may be copied, photocopied, reproduced, translated or reduced to any electronic medium or machine-readable form, in whole or in part, without prior written consent of Mullet's Products, Inc. All materials are protected by United States Copyright Law.

Date : May. 23, 19
Customer : MULLET'S ALUMINUM

Drawn By : Nick, L.
Project Name : VERTICAL PICKET RAIL

Scale : N.T.S.
Drawing Description : VRS - 100 Component List
Page : (3)



6345 McIntosh Road Office # (941) 371 - 3502
Sarasota, FL 34238 Fax # (941) 378 - 5676