

Material List:

1-15/16" x 1/8"	6061-T6 1-1/2" Sch 40-P	Top Cap (Shown)
13/16" x 1/8"	6061-T6 1/2" Sch 40-P	Vertical Tube
2" x 1/2"	6061-T6 Flat Bar	Top Horz. Rail
13/16" x 1/8"	6061-T6 1/2" Sch 40-P	Typ. Horz. Rails
2" x 1/2"	6061-T6 Flat Bar	Support Post
1/2" Thick	6061-T6 CNC Cut	Post Base Doubler
1/2" Thick	6061-T6 CNC Cut	Base Plates (Option)

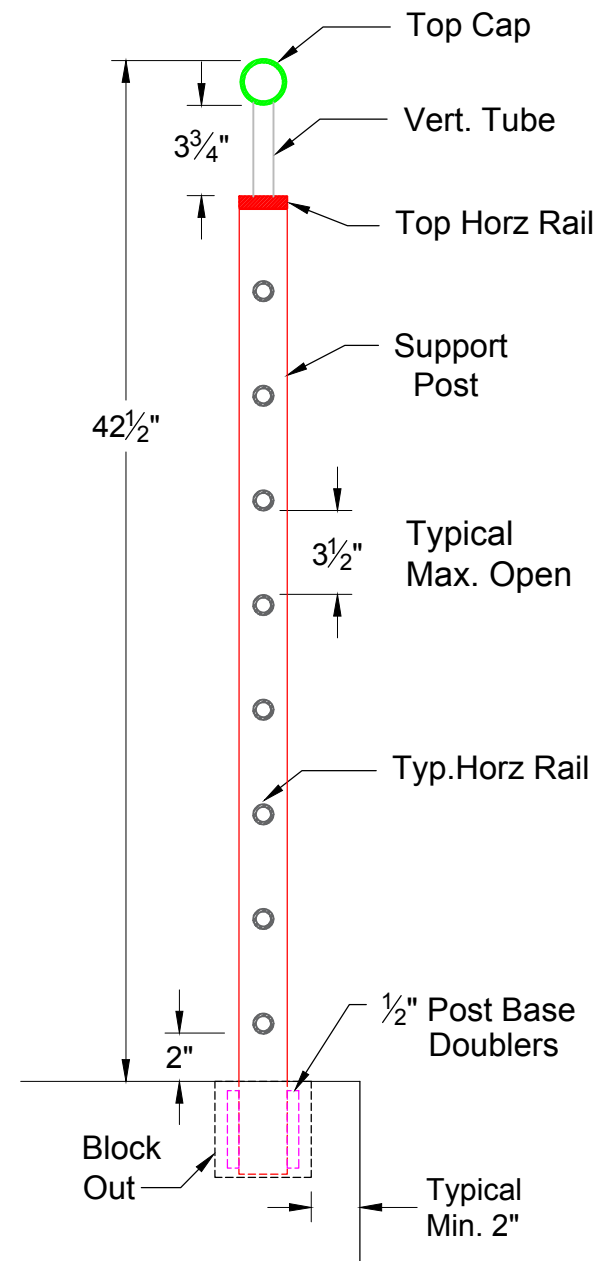

ENLARGED SECTION 1 1/2" = 1' - 0"

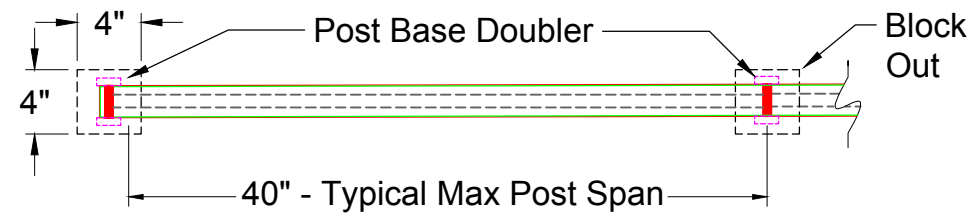

PLAN VIEW 1" = 1' - 0"

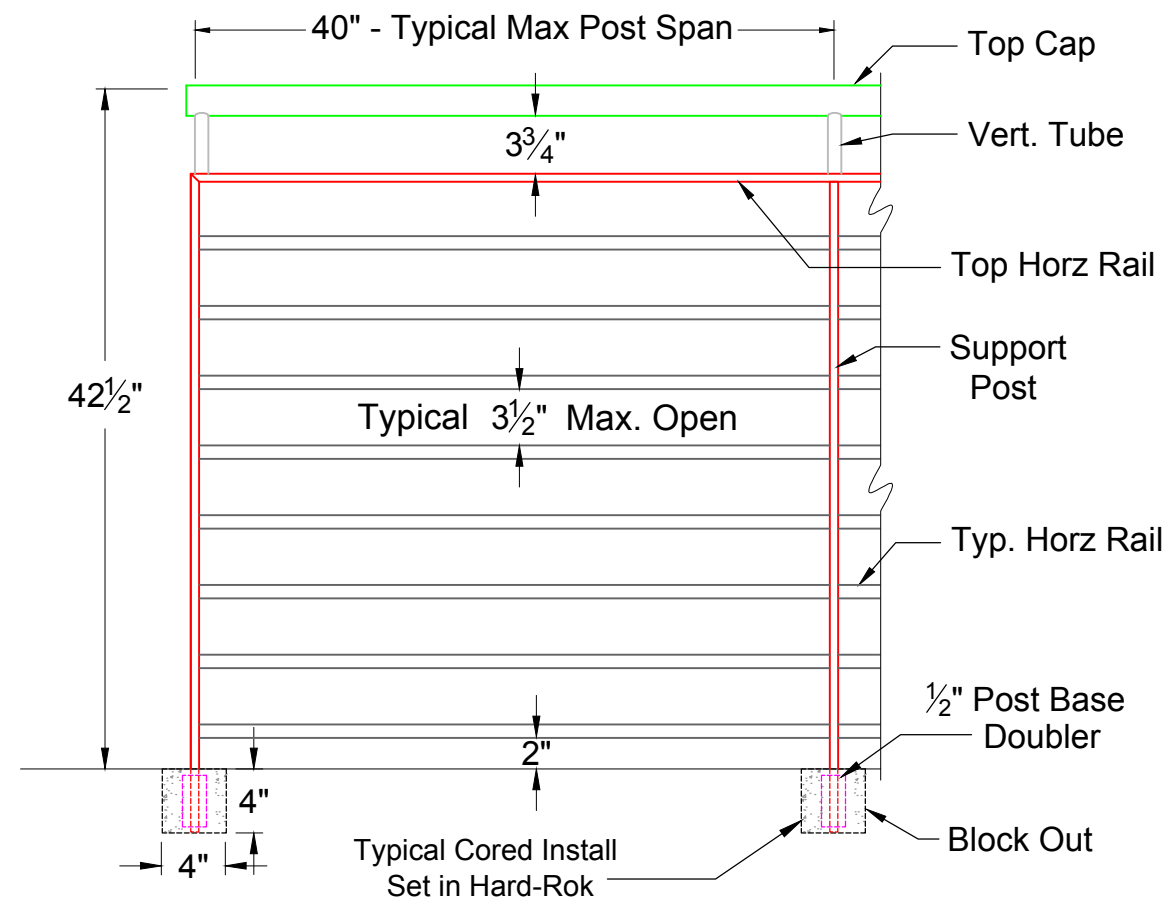

ELEVATION 1" = 1' - 0"

All rights reserved and are the property of Mullet's Aluminum Products, Inc. No part of the materials may be copied, photocopied, reproduced, translated or reduced to any electronic medium or machine-readable form, in whole or in part, without prior written consent of Mullet's Products, Inc. All materials are protected by United States Copyright Law.

Customer: **MULLET'S ALUMINUM**

Date: May. 23, 19

Drawn By: Nick, L.

Scale: AS NOTED

Page: (1)

Drawing Description: HRS - 400 Typ. Core Mount



6345 McIntosh Road Office # (941) 371 - 3502
Sarasota, FL. 34238 Fax # (941) 378 - 5676

Dimensions and Components may vary based on Site Specific Engineering

Material List:

1-15/16" x 1/8"	6061-T6 1-1/2" Sch 40-P	Top Cap (Shown)
13/16" x 1/8"	6061-T6 1/2" Sch 40-P	Vertical Tube
2" x 1/2"	6061-T6 Flat Bar	Top Horz. Rail
13/16" x 1/8"	6061-T6 1/2" Sch 40-P	Typ. Horz. Rails
2" x 1/2"	6061-T6 Flat Bar	Support Post
1/2" Thick	6061-T6 CNC Cut	Post Base Doubler
1/2" Thick	6061-T6 CNC Cut	Base Plates (Option)

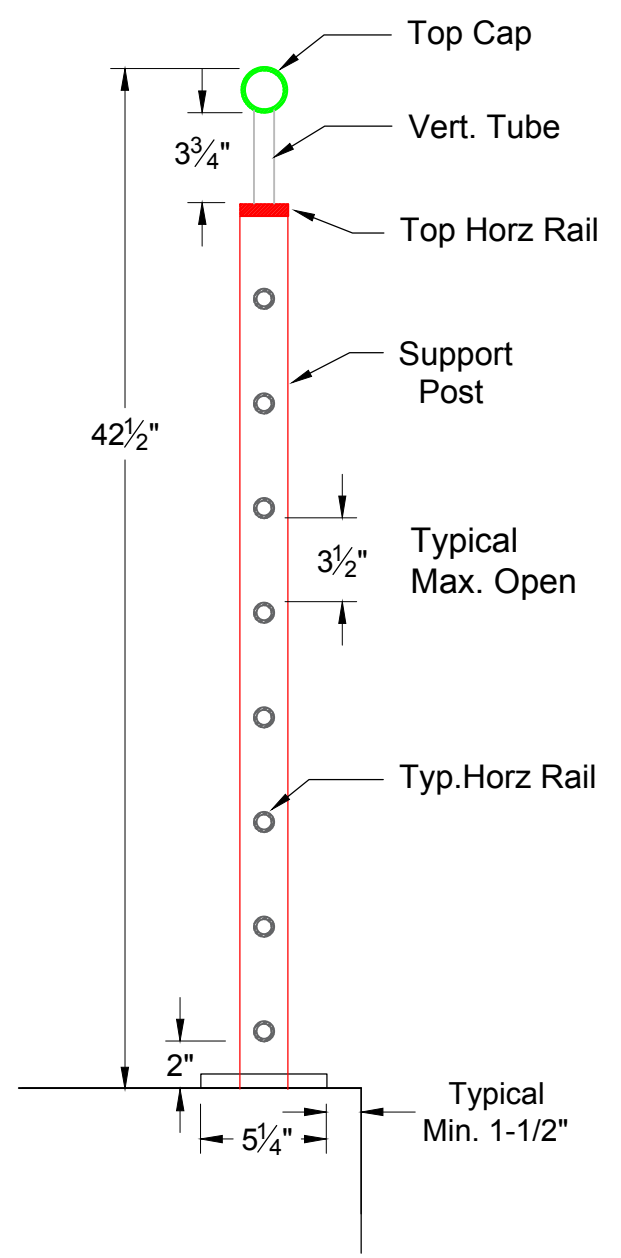

ENLARGED SECTION 1/2" = 1' - 0"

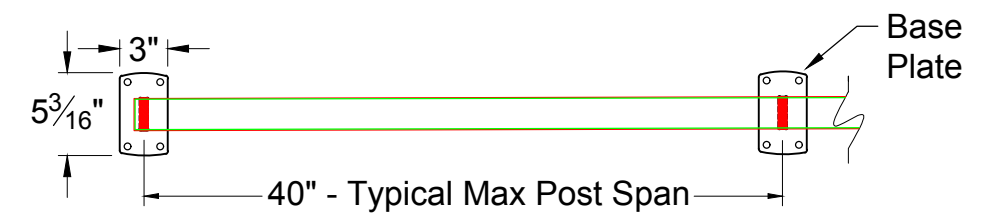

PLAN VIEW 1" = 1' - 0"

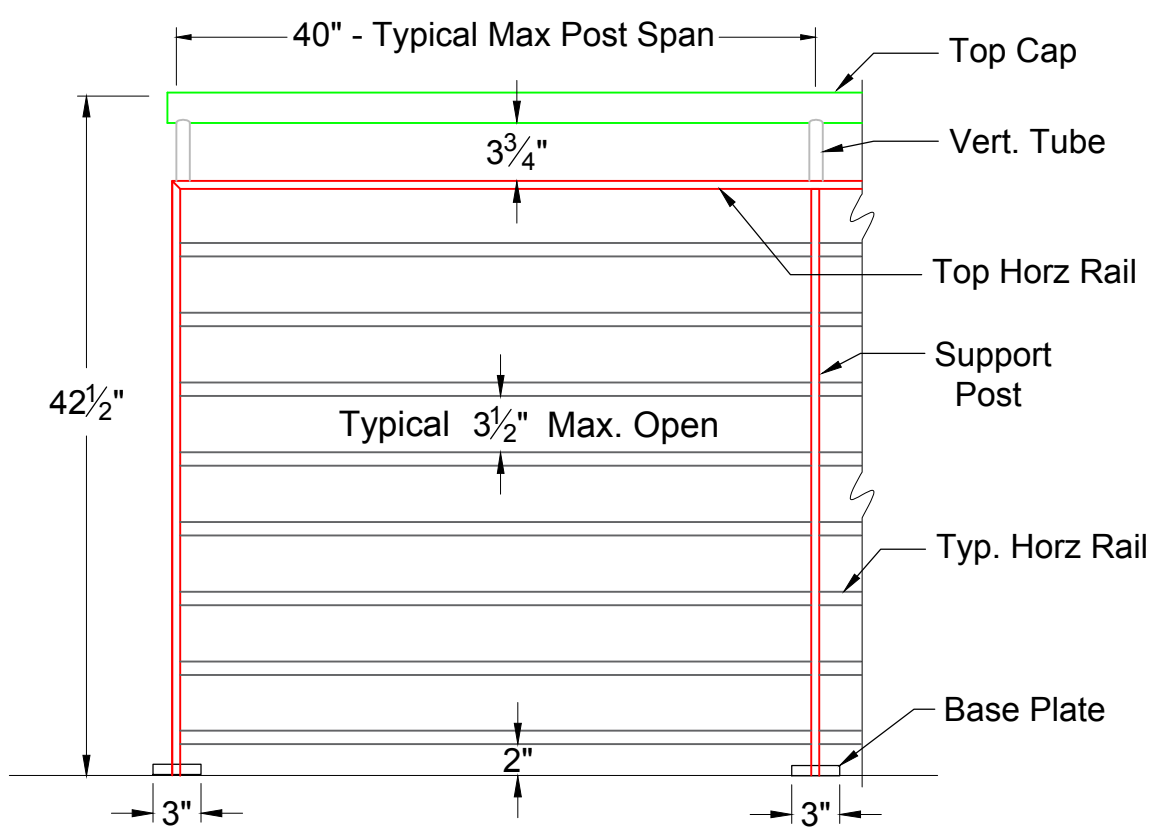

ELEVATION 1" = 1' - 0"

All rights reserved and are the property of Mullet's Aluminum Products, Inc. No part of the materials may be copied, photocopied, reproduced, translated or reduced to any electronic medium or machine-readable form, in whole or in part, without prior written consent of Mullet's Products, Inc. All materials are protected by United States Copyright Law.

Customer: MULLET'S ALUMINUM		Project Name:	Drawing Description:
Date: May. 23, 19	Drawn By: Nick, L.		
Scale: AS NOTED		Page: (2)	

MULLET'S ALUMINUM PRODUCTS INC.
WELDING FABRICATION DEPT.
 6345 McIntosh Road Office # (941) 371 - 3502
 Sarasota, FL 34238 Fax # (941) 378 - 5676

Dimensions and Components may vary based on Site Specific Engineering

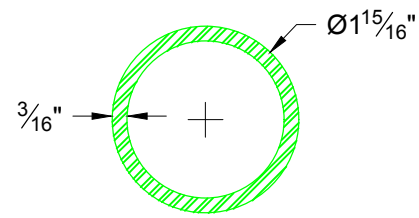

TOP CAP (SHOWN)
1 1/2" SCH 40 -PIPE

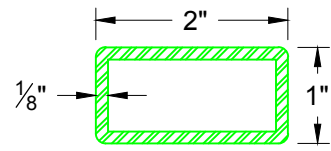

TOP CAP OPTION
2" x 1" TUBE RAD. EDGE

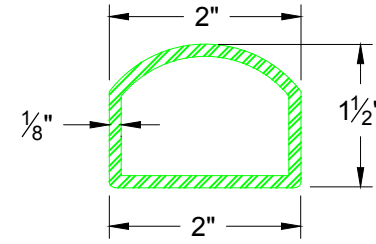

TOP CAP OPTION
MA 14

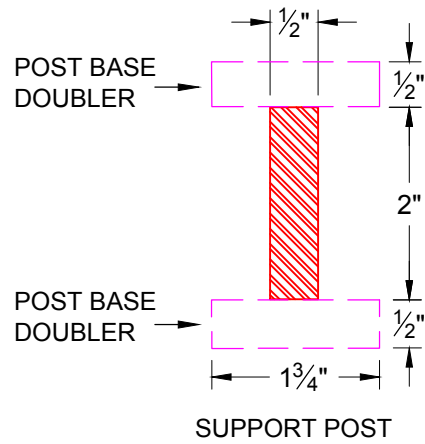

SUPPORT POST

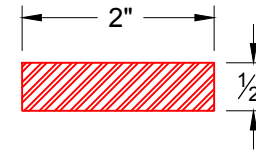

TOP HORZ RAIL

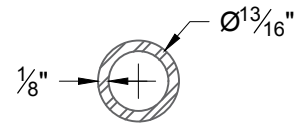

VERTICAL TUBE
&
TYP. HORZ RAIL
1/2" SCH 40 -PIPE

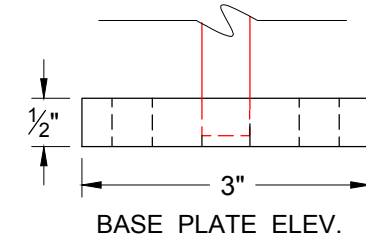

BASE PLATE ELEV.

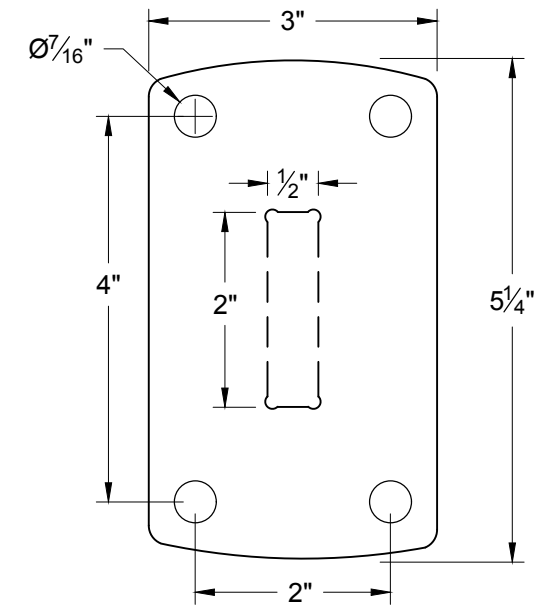

BASE PLATE PLAN

(BASE PLATE OPTION SUBJECT TO ENGINEERING)

Material List:

1-15/16" x 1/8"	6061-T6 1-1/2" Sch 40-P	Top Cap (Shown)
13/16" x 1/8"	6061-T6 1/2" Sch 40-P	Vertical Tube
2" x 1/2"	6061-T6 Flat Bar	Top Horz. Rail
13/16" x 1/8"	6061-T6 1/2" Sch 40-P	Typ. Horz. Rails
2" x 1/2"	6061-T6 Flat Bar	Support Post
1/2" Thick	6061-T6 CNC Cut	Post Base Doubler
1/2" Thick	6061-T6 CNC Cut	Base Plates (Option)

All rights reserved and are the property of Mullet's Aluminum Products, Inc. No part of the materials may be copied, photocopied, reproduced, translated or reduced to any electronic medium or machine-readable form, in whole or in part, without prior written consent of Mullet's Products, Inc. All materials are protected by United States Copyright Law.

Customer: **MULLET'S ALUMINUM**

Date: May. 23, 19

Drawn By: Nick, L.

Scale: N.T.S.

Page: (3)

Drawing Description: HRS - 400 Component List



6345 McIntosh Road Office # (941) 371 - 3502
Sarasota, FL. 34238 Fax # (941) 378 - 5676